



KENNESAW STATE
UNIVERSITY

Facilities

February 27, 2020

Facilities – AiM – Work Order System <https://aimweb.kennesaw.edu/>

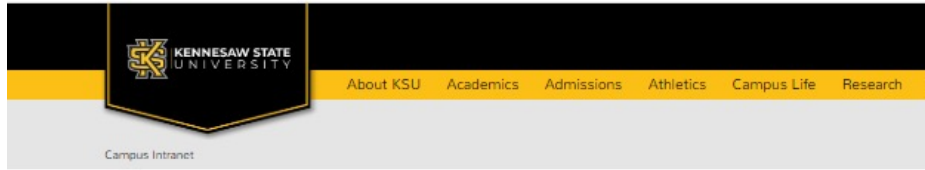

Campus Intranet

Campus Sites

- Academic Affairs
- Accreditation
- AiM Requests / Maintenance Request Form**
- Alumni Relations
- Athletics
- Calendars | Request Space for an Event
- Campus Forms
- Campus Maps
- Campus Postal Services and Maildrop Numbers
- Campus Services
- Career Planning and Development (Handshake)
- Compliance and Reporting Ethics Hotline
- Copy/Print Services
- Digital Learning Innovations
- Diversity & Inclusion
- Division of Global Affairs
- Door Access
- Emergency Management
- Enrollment Services
- Enterprise Reports Login
- Environmental Health & Safety
- Event and Venue Management
- Fact Book
- Faculty Handbook
- Financial Aid
- Fiscal Services
- Human Resources
- KSU Catering
- KSU Mail
- KSU Online
- KSU Today
- Legal Affairs
- Maintenance Request Form**
- Parking and Transportation
- Payroll Services
- Phone Directory
- Policy Portal
- Public Safety / Police
- Registrar
- Research at KSU
- Risk Management
- Student Services
- University News
- University Stores
- Undergraduate Admissions

NetID

- NetID.Kennesaw.edu
- Activate NetID Account Now

Fiscal Services

- Fiscal Services Home
- Accounting
- Accounts Payable
- Budget
- Bursar
- Contracts
- Payroll
- Procurement
- Travel

Online Resources

- Banner Student Information System
- Chematrix (Chemical Management)
- D2L Brightspace
- DocuSign
- GA Voicemail
- Handshake
- HireTouch
- Internal Job Postings
- KSU Connect
- KSU Status
- KSU Today
- KSUmail
- Noli Web
- OneUSG Login
- OWI Express
- OWI CEC Login
- Works (IP-Card) Payment Manager

Computing Resources

- BrightSpace D2L Support
- Library & Database Services
- Premier Dell
- Technology Purchases



Need help?

Submitting a new request

Viewing Work Orders

For Facilities Maintenance emergencies or inquiries regarding AiM Work Orders, please contact Plant Operations at 470-578-6224, Monday - Friday, 7:00AM - 5:00PM

For after-hours emergencies only, please contact Public Safety at 470-578-6206.

For all Housing Maintenance issues, please contact Housing at 470-578-5483.

For problems logging in to the AiM Customer Portal, please contact the UITS Service Desk: at 470-578-6999 or email service@kennesaw.edu

Sign In

NetID

Password

Sign In



View Open Work Orders

View Pending Work Orders

View Closed Work Orders

Submit A New Work Request

Logout

Support

New Maintenance Request

Campus

Kennesaw

Building

585 Kennesaw Hall

Room

1001 - Office

Problem

Too Cold -

Description

Too cold in 1001

234 Characters Left

Phone (123-456-7890 or ex 1234)

6224

Submit

Facilities – Building Information

Building Gross Square Feet – 7,993,467 TOTAL
 Kennesaw Campus – 350.77 Acres, Marietta Campus – 193.2 Acres

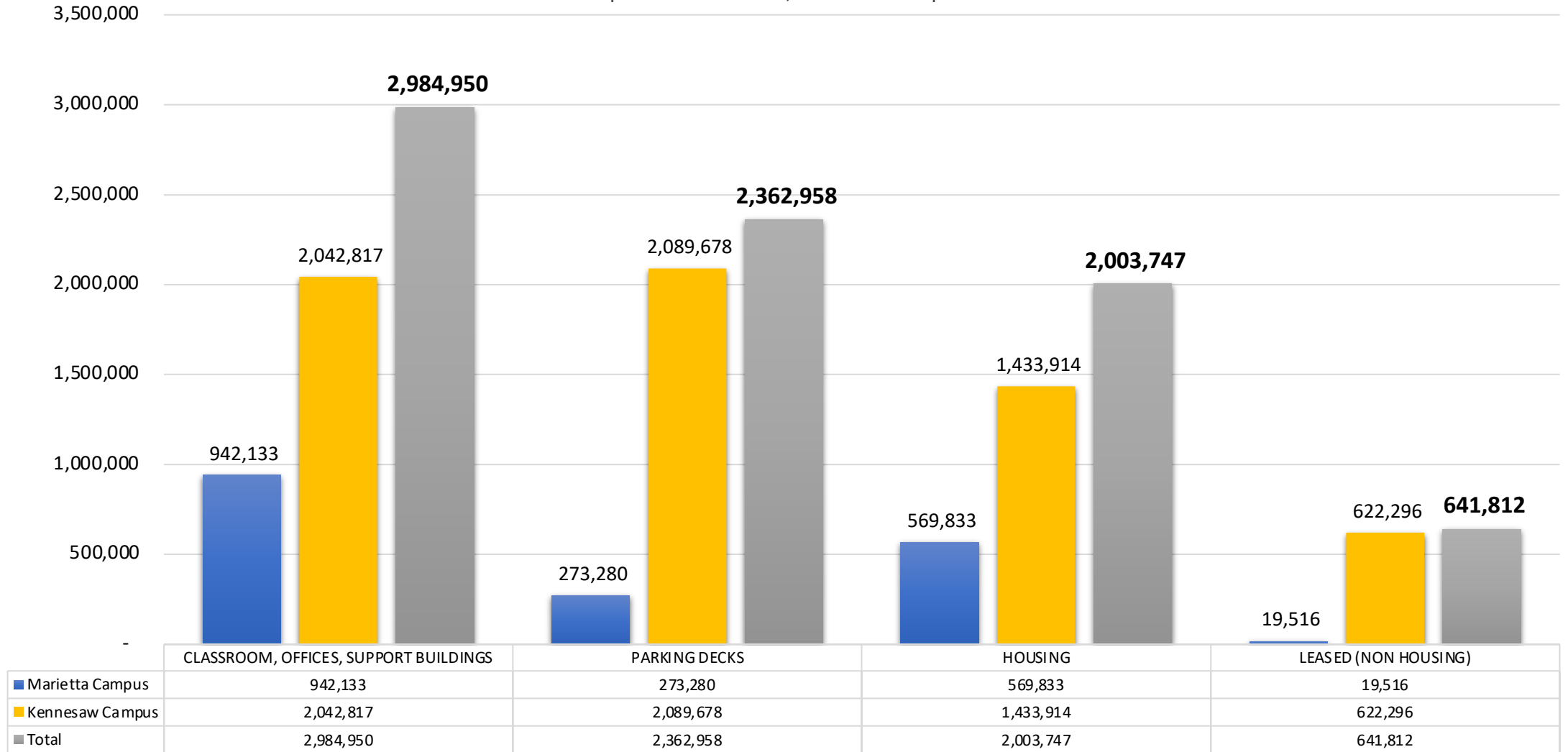

(Source: Facilities Inventory Data Collection/ USG Data Store, Spring 2019)

GSF (Gross Square Feet) of KSU Space By Space Type

Category	Type/Use of Space	Kennesaw Campus	Marietta Campus	GSF TOTAL
100	Classrooms + Service	149,653	62,160	211,813
200	Discipline Classrooms, Laboratories + Service	269,764	181,509	451,273
300	Office (includes Administrative areas and conference rooms)	578,396	152,107	730,503
400	Library and Study Space	73,026	45,742	118,768
500	Special Use	263,624	55,489	319,113
600	General Use	155,297	84,152	239,449
700	Support (<i>does not include parking decks</i>)	63,252	29,974	97,858
800	Health Care	2,998	759	3,757
900	Residential/Student Housing	1,358,449	419,199	1,777,648
000	Unassignable (Mechanical/Utilities, Circulation, Restrooms)	1,179,936	500,391	1,680,327
700	Parking Decks	2,089,678	273,280	2,362,958
	TOTAL SF	2,919,091	1,031,091	7,993,467

(Source: Facilities Inventory Data Collection/ USG Data Store, Spring 2019)

Capital Projects

Fiscal Year	Project	Campus	Capital Outlay	Notes
2018	Science Lab Annex to Engineering Lab Building	Marietta	\$5,000,000 Design & Construction	Completion March, 2020
2018, 2017	Chastain Pointe 115 Renovation for COTA / Visual Arts	Kennesaw	\$2,970,000	Completion April, 2020
2020	Academic Learning Center	Kennesaw	\$39,500,000 Construction	Completion Spring, 2022
2019	Engineering Lab Building Renovation	Marietta	\$5,000,000 Design & Construction	Construction Starts May, 2020
2020	Howell Hall Renovation	Marietta	\$12,000,000	Completion July, 2021
2020	New Housing Construction	Kennesaw	\$37,000,000	Completion July, 2022
2020	Student Rec Center Renovation	Marietta	\$5,000,000	Integrated Review Underway
2021	Science Building Chemistry Lab Renovation	Kennesaw	\$2,000,000	Included on FY21-24 Capital Plan

Marietta Campus: Science Lab Annex to Engineering Lab Building (G)



Schematic Design / Construction Underway – Completion March 2020

Kennesaw Campus Academic Learning Center



Schematic Design / Ground-Breaking March 2020

Academic Learning Center, Level 1 Plan:

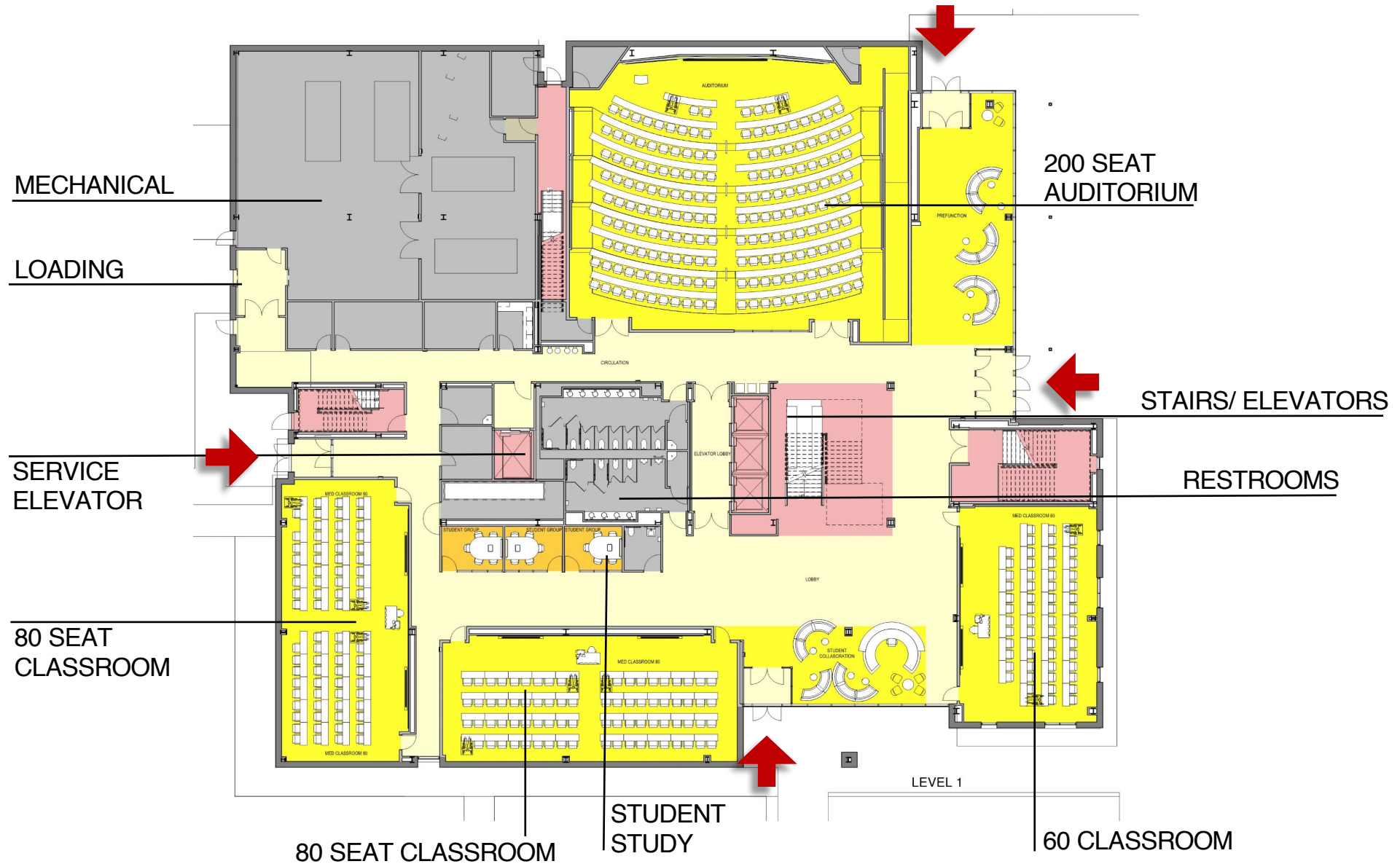

Academic Learning Center, Level 2 Plan:



LEVEL 2

Academic Learning Center, Level 3 Plan:



Academic Learning Center, Level 4 Plan:



Academic Learning Center, Level 5 Plan:



Major Repair and Renovation (MRR)

Institutions use MRR funding for projects that involve major repair, replacement, or renovation of critical building systems, site components and infrastructure. MRR funding works in conjunction with maintenance and operations (M&O) funding and capital funding (for large or comprehensive renovation projects) to fulfill institutional stewardship responsibilities and protect the State of Georgia's investment in higher education facilities. – USG system website

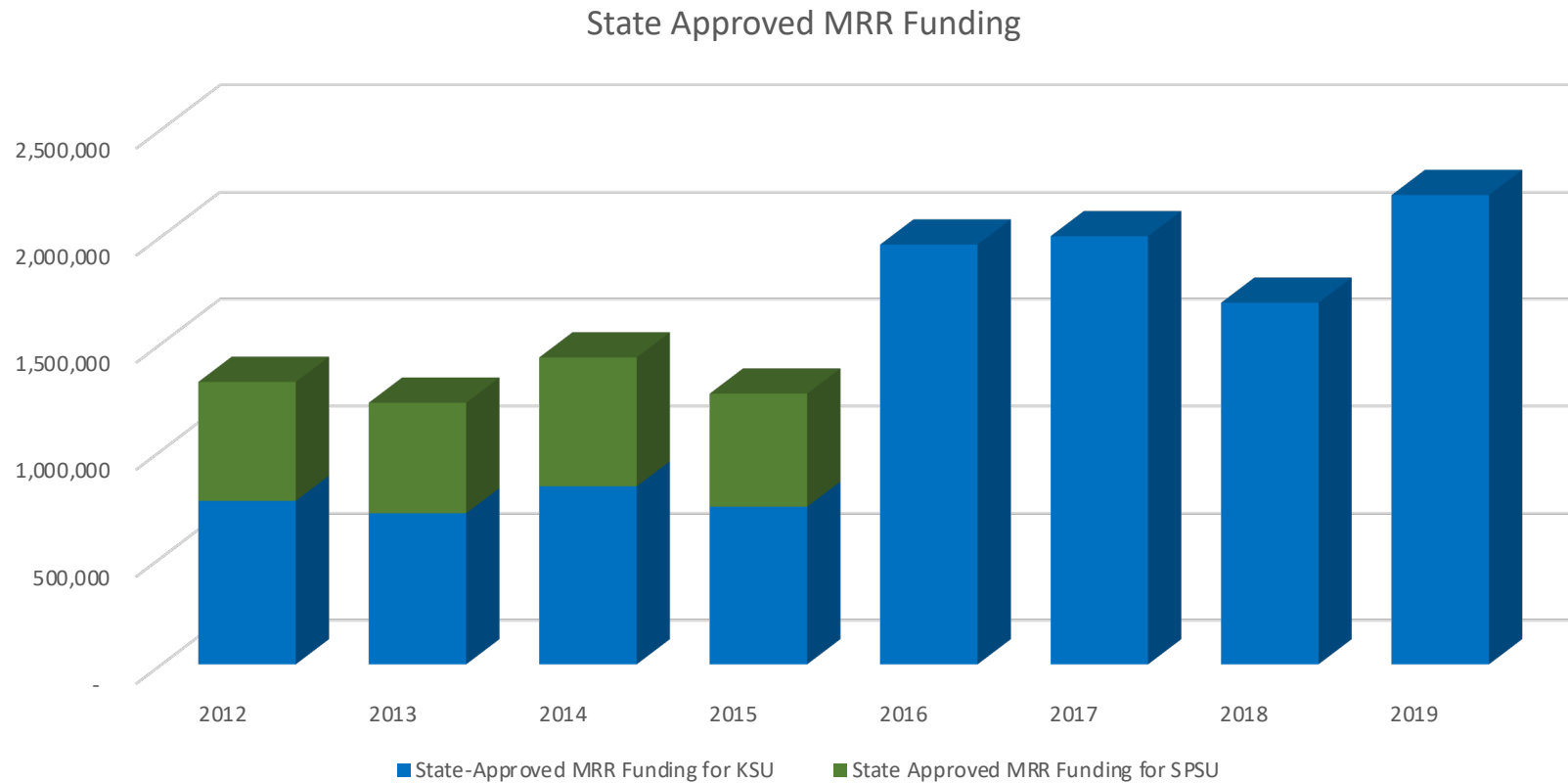

KSU and SPSU consolidated in Fall 2015 (FY 2016)

PROJECT PROCESS

